

# Servo Modifications for "on/off" Geared Motor Applications

Tom Guglielmo

Applications: Radar, Winch, Cranes

- 1) Remove four long retention screws (22) from bottom of servo.
- 2) Remove top servo gear cover. (1)
- 3) Remove center gear (13)
- 4) Remove pot gear (14) and cut gear stop from top of gear.

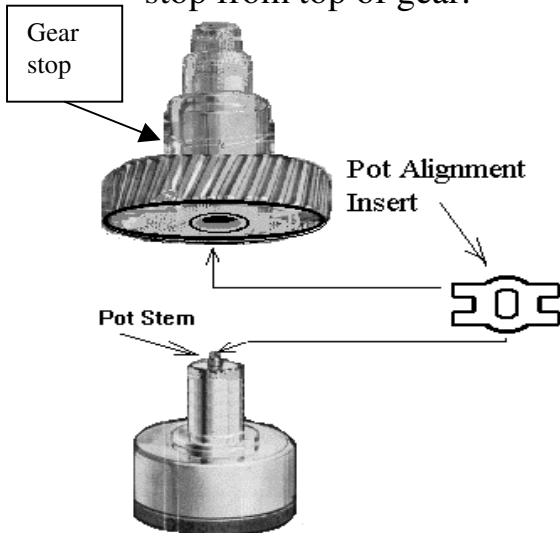

- 5) With small screwdriver remove pot alignment insert keeper ring (5)
- 6) Remove pot alignment insert (7)
- 7) Remove circuit board and motor.
- 8) Cut all three wires at pot
- 9) Cut two motor wires at circuit board (H)
- 10) Cut three servo lead wires at circuit board (12)
- 11) Discard white wire and solder red and black wires to motor.
- 12) Replace servo gears & cover
- 13) Remove servo connector and run black and red wires to 1.5 volt source.

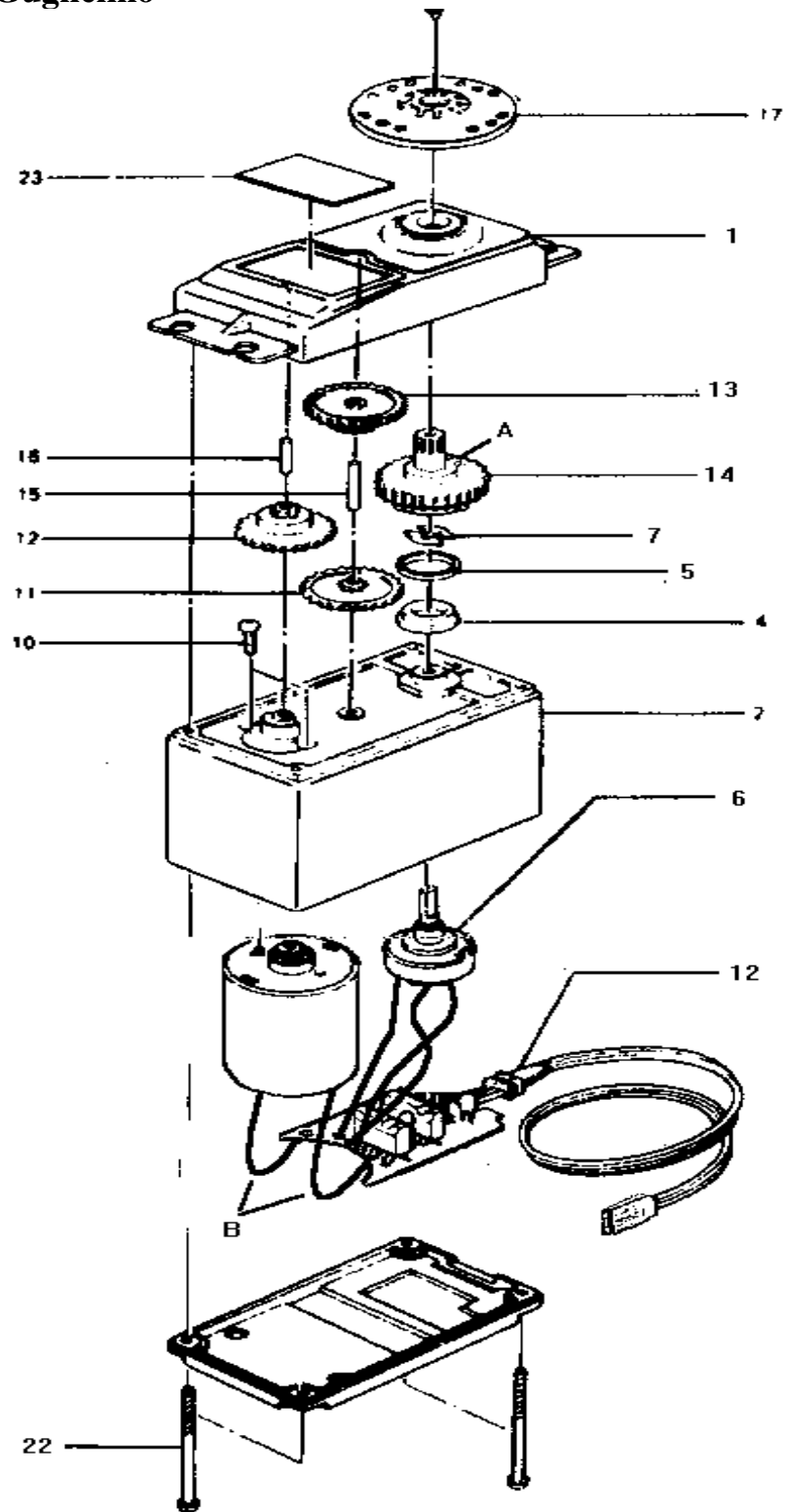

This document is intended for private use only and may not be copied and/or distributed without the written permission of the author or the president of the Northwest R/C Ship Modelers.